

ADI Supply - RTA Kitchen Cabinets - Call Vickie 386-761-4946 or [vickie@adisupply.com](mailto:vickie@adisupply.com) or **FAX 888-761-8050**

Please send us a rough sketch of your project....A (bird's eye) view with wall measurements and locations for your appliances, sink, window, door, etc. The information you provide us with can have a great weight on the success of your project. See page 2 (below) for example and instructions..

**NAME:**

**EMAIL:**

**PHONE:**

**Ship to ZIP Code:**

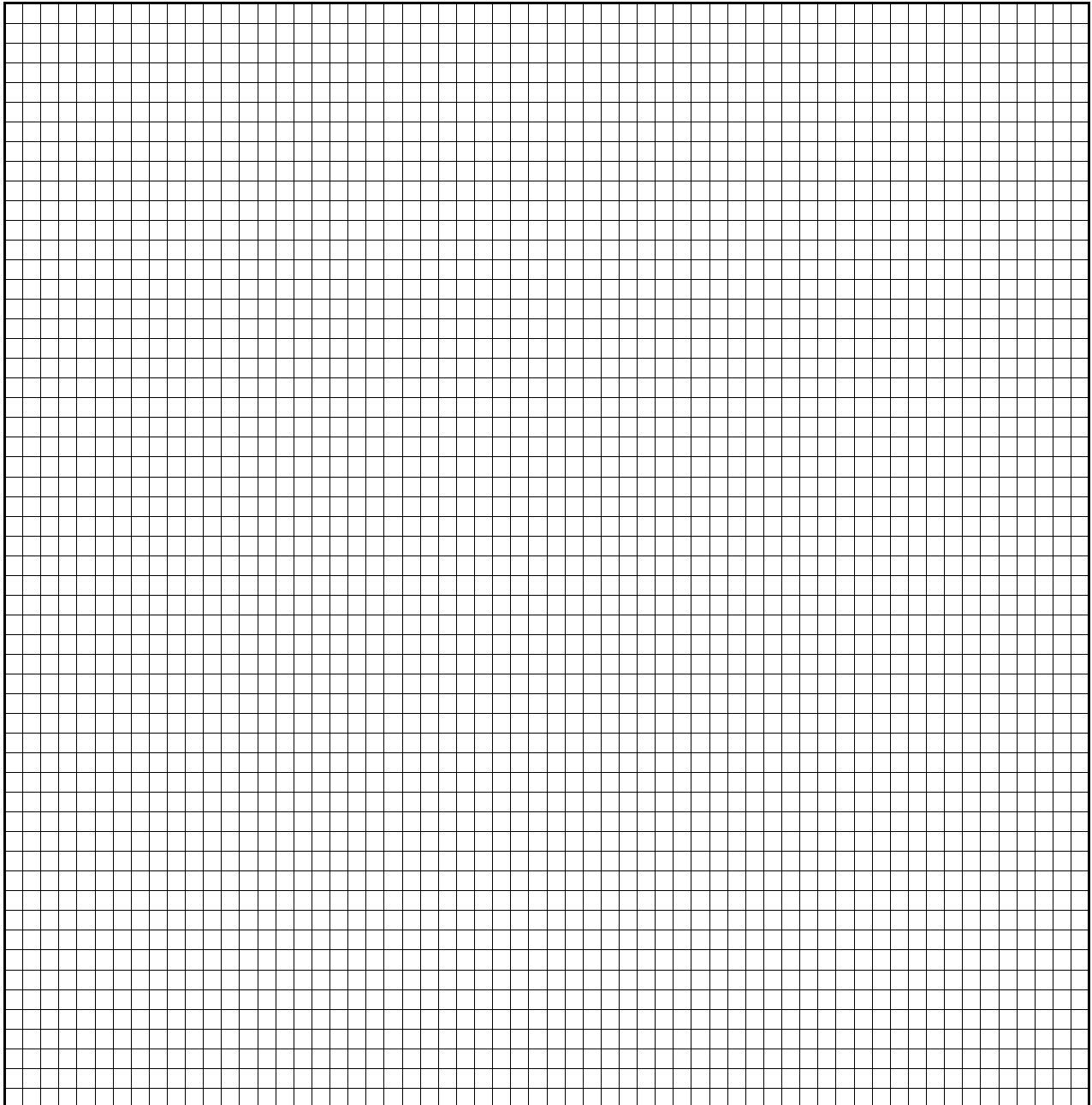

## Sample Sketch

ADI Supply - RTA Kitchen Cabinets - Call Vickie 386-761-9949 or vickie@adisupply.com or FAX 888-761-5669

Please send us a rough sketch of your project... A (bird's eye) view with wall measurements and locations for your appliances, sink, window, door, etc. The information you provide us with can have a great weight on the success of your project. See page 2 (below) for example and instructions..

NAME: V. Davis      EMAIL: Vickie@adisupply.com      PHONE: 386-761-4946

Ship to ZIP Code: 32119

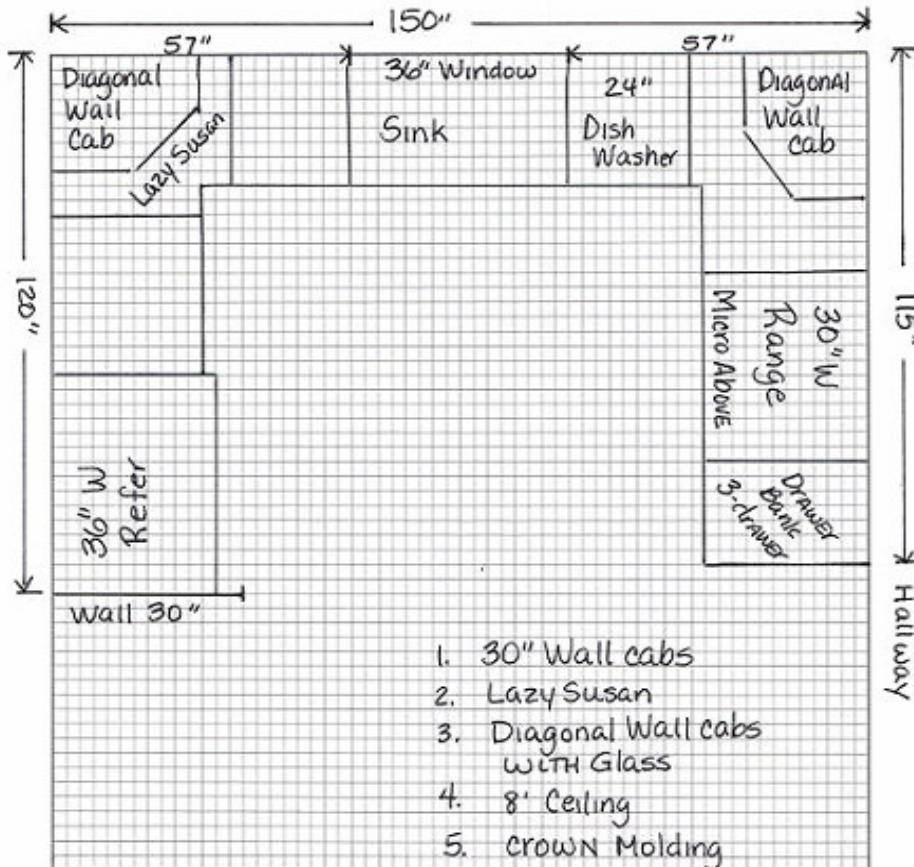

They say a picture is worth a thousand words..... very true here! These are a few of the things we need to know... Most important are the wall measurements. If you want cabinets on a wall, we need to know how long the wall is and if there are any obstacles or places where you don't want cabinets. If windows or doors, Please let us know the width and height (including any border trim). We will also need to know the window or door distance from the nearest wall corner or reference point. If you need your sink centered under a window....we need to know the exact location of the window. Standard refrigerator openings are 36" wide by 72" high... Standard free standing range openings are 30"+ wide and a standard dishwasher opening is 24"+ wide. If your needs vary from this, please let us know. Standard wall cabinet height is 30",

please indicate if you would like 36" and or 42" high uppers or a combination of different heights for that staggered look. Please be aware that 36" uppers are not available in all lines. Another helpful bit of info will be which door style you are interested in. This allows us to design your layout using the parts we know are available .... in other words, there is no point is us presenting you with a layout using parts that are not available in your selected door style.

*Unfortunately, our FREE DESIGN ASSISTANCE time is quite limited. We simply do not have the ability to provide a full blown design service with multiple layouts and views. Please help us serve you by giving us accurate information up front and we will work hard to get your design and quote back to you in a timely manner.*

**We know there are a lot of cabinetry choices out there and truly appreciate the opportunity you have given us by allowing us to bid your project.**